

# E24 I 84BS

## TERMINALI + CONNETTORI

### Terminale

Materiale: Ottone  
 Portata massima: 1A @ 125V AC/DC  
 Adatto a filo da AWG #28-#22  
 Finitura: Stagnato E24I84BS-2  
 Flash d'Oro E24I84BS-00  
 Utilizzabile nelle serie EBHI / EBH2  
 Estrattore: EU594F

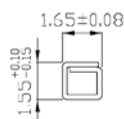
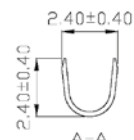
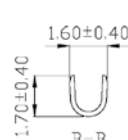
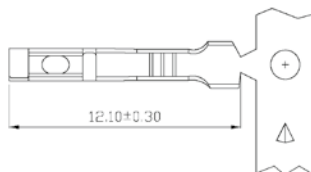
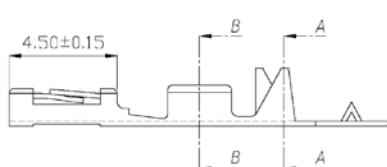
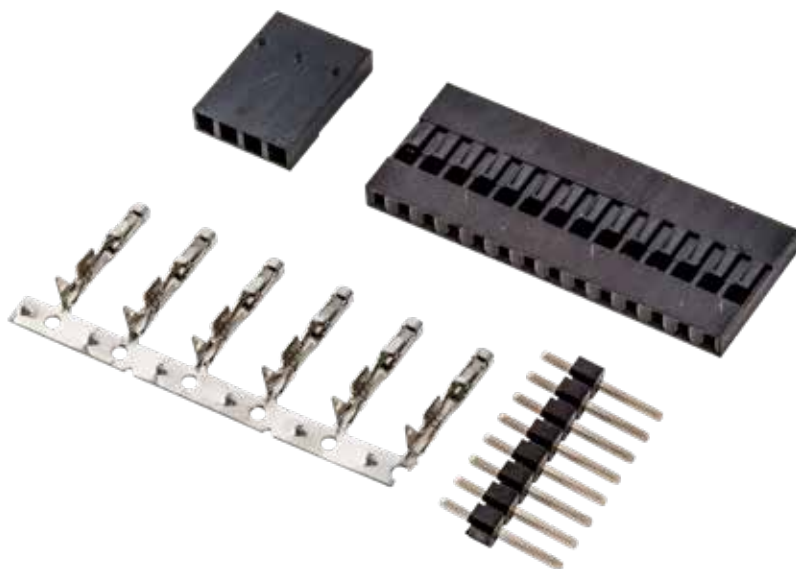

CODICE	SEZ. FILO	MATERIALE	SPESS.	FINITURA	A	B	C	D	DIAM. ISOLANTE	Q.TÀ PER BOBINA
E24I84BS-2	AWG 22 - 28	Ottone	0,20	Stagnato	2,40	2,40	1,60	1,70	1,50	10.000pz
E24I84BS-00	AWG 22 - 28	Ott.-Dorato	0,20	Flash oro	2,40	2,40	1,60	1,70	1,50	10.000pz

# EBHI

## TERMINALI + CONNETTORI

### Connettore passo 2.54 mm

Materiale: Nylon UL 94V-I  
 Portata massima: 1A @ 125V AC/DC  
 Colore standard: Nero  
 Utilizza entrambi i terminali serie E24I84BS  
 Interconnessione diretta con le serie: EM24I84/R  
 Disponibile da 1 a 40 vie

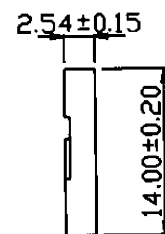
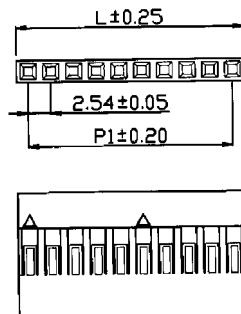

N° DI VIE	CODICE	A (mm)	B (mm)	N° DI VIE	CODICE	A (mm)	B (mm)
1	EBHI-01	--	2.54	21	EBHI-21	50.80	53.34
2	EBHI-02	2.54	5.08	22	EBHI-22	53.34	55.88
3	EBHI-03	5.08	7.62	23	EBHI-23	55.88	58.42
4	EBHI-04	7.62	10.16	24	EBHI-24	58.42	60.96
5	EBHI-05	10.16	12.70	25	EBHI-25	60.96	63.50
6	EBHI-06	12.70	15.24	26	EBHI-26	63.50	66.04
7	EBHI-07	15.24	17.78	27	EBHI-27	66.04	68.58
8	EBHI-08	17.78	20.32	28	EBHI-28	68.58	71.12
9	EBHI-09	20.32	22.86	29	EBHI-29	71.12	73.66
10	EBHI-10	22.86	25.40	30	EBHI-30	73.66	76.20
11	EBHI-11	25.40	27.94	31	EBHI-31	76.20	78.74
12	EBHI-12	27.94	30.48	32	EBHI-32	78.74	81.28
13	EBHI-13	30.48	33.02	33	EBHI-33	81.28	83.82
14	EBHI-14	33.02	35.56	34	EBHI-34	83.82	86.36
15	EBHI-15	35.56	38.10	35	EBHI-35	86.36	88.90
16	EBHI-16	38.10	40.64	36	EBHI-36	88.90	91.44
17	EBHI-17	40.64	43.18	37	EBHI-37	91.44	93.98
18	EBHI-18	43.18	45.72	38	EBHI-38	93.98	96.52
19	EBHI-19	45.72	48.26	39	EBHI-39	96.52	99.06
20	EBHI-20	48.26	50.80	40	EBHI-40	99.06	101.60

# EM24I84/EM24I84R

## TERMINALI + CONNETTORI

### Maschi dritti e a 90°

passo 2.54 mm

Materiale: P.B.T. UL 94V-0

Portata massima: 1A @ 125V AC/DC

Contatti: Ottone

Pin quadro (0.64mm)

Finitura: Flash d'oro

Interconnessione diretta con la serie EBHI

Disponibile da 1 a 40 vie

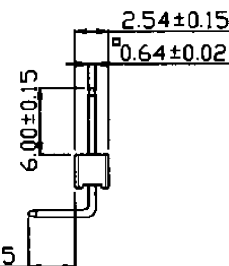
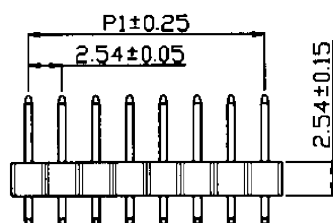
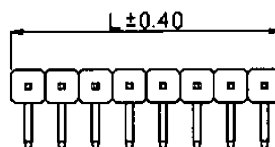
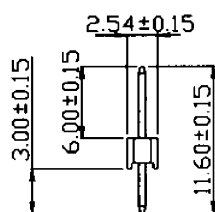
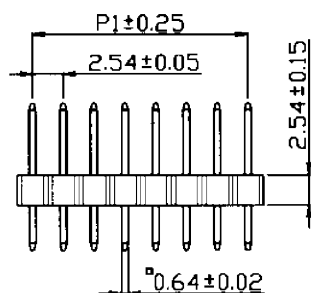
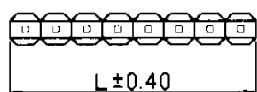

MASCHIO  
DRITTO

MASCHIO  
A 90°

N° DI VIE	CODICE		DIMENS. (mm)	
	DRITTI	A 90°	PI	L
1	EM24I841	EM24I841R	--	2.54
2	EM24I842	EM24I842R	2.54	5.08
3	EM24I843	EM24I843R	5.08	7.62
4	EM24I844	EM24I844R	7.62	10.16
5	EM24I845	EM24I845R	10.16	12.70
6	EM24I846	EM24I846R	12.70	15.24
7	EM24I847	EM24I847R	15.24	17.78
8	EM24I848	EM24I848R	17.78	20.32
9	EM24I849	EM24I849R	20.32	22.86
10	EM24I8410	EM24I8410R	22.86	25.40
11	EM24I8411	EM24I8411R	25.40	27.94
12	EM24I8412	EM24I8412R	27.94	30.48
13	EM24I8413	EM24I8413R	30.48	33.02
14	EM24I8414	EM24I8414R	33.02	35.56
15	EM24I8415	EM24I8415R	35.56	38.10
16	EM24I8416	EM24I8416R	38.10	40.64
17	EM24I8417	EM24I8417R	40.64	43.18
18	EM24I8418	EM24I8418R	43.18	45.72
19	EM24I8419	EM24I8419R	45.72	48.26
20	EM24I8420	EM24I8420R	48.26	50.80

N° DI VIE	CODICE		DIMENS. (mm)	
	DRITTI	A 90°	PI	L
21	EM24I8421	EM24I8421R	50.80	53.34
22	EM24I8422	EM24I8422R	53.34	55.88
23	EM24I8423	EM24I8423R	55.88	58.42
24	EM24I8424	EM24I8424R	58.42	60.96
25	EM24I8425	EM24I8425R	60.96	63.50
26	EM24I8426	EM24I8426R	63.50	66.04
27	EM24I8427	EM24I8427R	66.04	68.58
28	EM24I8428	EM24I8428R	68.58	71.12
29	EM24I8429	EM24I8429R	71.12	73.66
30	EM24I8430	EM24I8430R	73.66	76.20
31	EM24I8431	EM24I8431R	76.20	78.74
32	EM24I8432	EM24I8432R	78.74	81.28
33	EM24I8433	EM24I8433R	81.28	83.82
34	EM24I8434	EM24I8434R	83.82	86.36
35	EM24I8435	EM24I8435R	86.36	88.90
36	EM24I8436	EM24I8436R	88.90	91.44
37	EM24I8437	EM24I8437R	91.44	93.98
38	EM24I8438	EM24I8438R	93.98	96.52
39	EM24I8439	EM24I8439R	96.52	99.06
40	EM24I8440	EM24I8440R	99.06	101.60

# EBH2

## TERMINALI + CONNETTORI

### Connettore

#### passo 2.54 mm

Materiale: P.B.T. - UL 94V-0

Portata massima: 1A @ 125V AC/DC

Colore standard: Nero

Utilizza i terminali serie E24184BS

Interconnessione diretta con le serie: EMD24184/R

Disponibile da 4 a 80 vie con o senza

PEG di polarizzazione

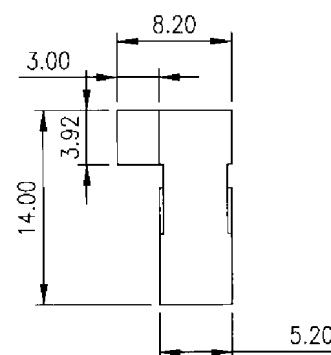
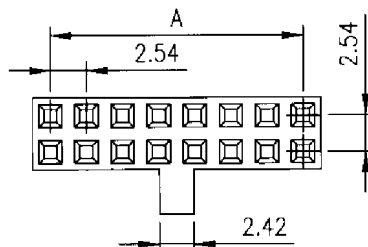
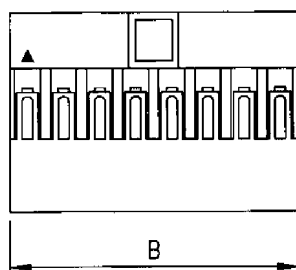
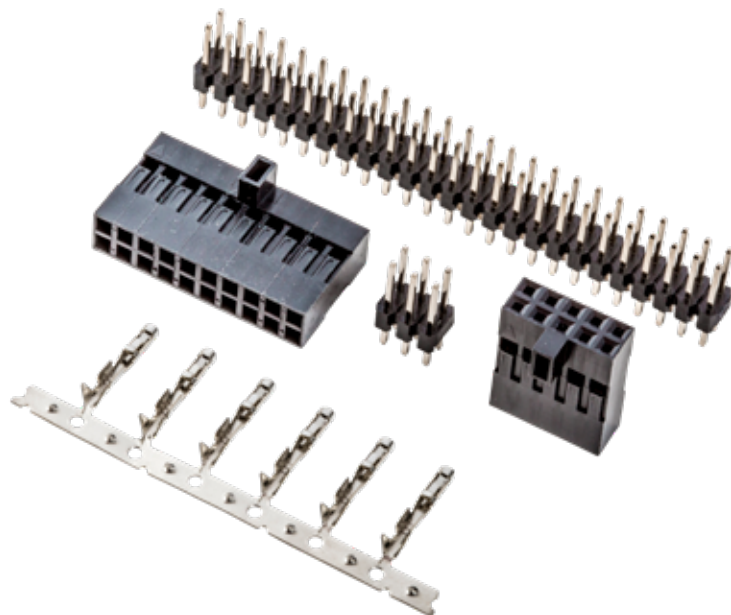

PEG = polarizzazione centrale

VIE	CODICE ELMAC	DIMENS.(MM)	
	CON PEG	A	B
2 x 1	EBH2-2x1Peg		2.54
2 x 2	EBH2-2x2Peg	2.54	5.08
2 x 3	EBH2-2x3Peg	5.08	7.62
2 x 4	EBH2-2x4Peg	7.62	10.16
2 x 5	EBH2-2x5Peg	10.16	12.70
2 x 6	EBH2-2x6Peg	12.70	15.24
2 x 7	EBH2-2x7Peg	15.24	17.78
2 x 8	EBH2-2x8Peg	17.78	20.32
2 x 9	EBH2-2x9Peg	20.32	22.86
2 x 10	EBH2-2x10Peg	22.86	25.40
2 x 11	EBH2-2x11Peg	25.40	27.94
2 x 12	EBH2-2x12Peg	27.94	30.48
2 x 13	EBH2-2x13Peg	30.48	33.02
2 x 14	EBH2-2x14Peg	33.02	35.56
2 x 15	EBH2-2x15Peg	35.56	38.10
2 x 16	EBH2-2x16Peg	38.10	40.64
2 x 17	EBH2-2x17Peg	40.64	43.18
2 x 18	EBH2-2x18Peg	43.18	45.72
2 x 19	EBH2-2x19Peg	45.72	48.26
2 x 20	EBH2-2x20Peg	48.26	50.80

VIE	CODICE ELMAC	DIMENS.(MM)	
	CON PEG	A	B
2 x 21	EBH2-2x21Peg	50.80	53.34
2 x 22	EBH2-2x22Peg	53.34	55.88
2 x 23	EBH2-2x23Peg	55.88	58.42
2 x 24	EBH2-2x24Peg	58.42	60.96
2 x 25	EBH2-2x25Peg	60.96	63.50
2 x 26	EBH2-2x26Peg	63.50	66.04
2 x 27	EBH2-2x27Peg	66.04	68.58
2 x 28	EBH2-2x28Peg	68.58	71.12
2 x 29	EBH2-2x29Peg	71.12	73.66
2 x 30	EBH2-2x30Peg	73.66	76.20
2 x 31	EBH2-2x31Peg	76.20	78.74
2 x 32	EBH2-2x32Peg	78.74	81.28
2 x 33	EBH2-2x33Peg	81.28	83.82
2 x 34	EBH2-2x34Peg	83.82	86.36
2 x 35	EBH2-2x35Peg	86.36	88.90
2 x 36	EBH2-2x36Peg	88.90	91.44
2 x 37	EBH2-2x37Peg	91.44	93.98
2 x 38	EBH2-2x38Peg	93.98	96.52
2 x 39	EBH2-2x39Peg	96.52	99.06
2 x 40	EBH2-2x40Peg	99.06	101.60

# EMD24I84/EMD24I84R

## TERMINALI + CONNETTORI

### Maschi dritti e a 90°

#### passo 2.54 mm

Materiale: P.B.T. UL 94V-0

Portata massima: 1A @ 125V AC/DC

Contatti: Ottone

Pin quadro (0.64mm)

Finitura: Flash d'oro

Interconnessione diretta con la serie EBHI

Disponibile da 1 a 40 vie

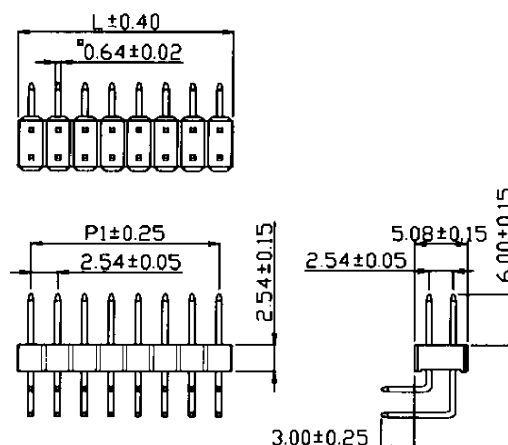
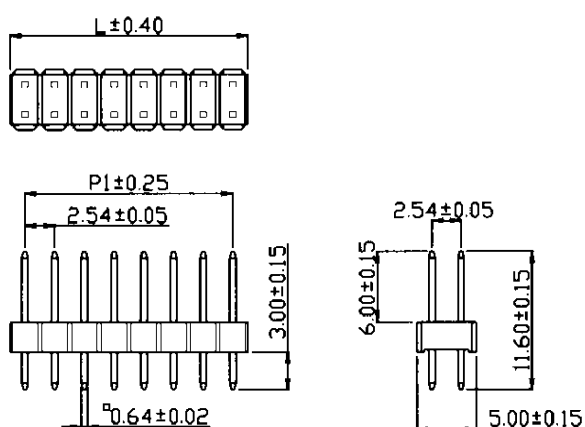

### MASCHIO DRITTO

### MASCHIO A 90°

N° DI VIE	CODICE		DIMENS. (MM)	
	DRITTI	A 90°	PI	L
2 x 1	EMD24I841	EMD24I841R	--	2.54
2 x 2	EMD24I842	EMD24I842R	2.54	5.08
2 x 3	EMD24I843	EMD24I843R	5.08	7.62
2 x 4	EMD24I844	EMD24I844R	7.62	10.16
2 x 5	EMD24I845	EMD24I845R	10.16	12.70
2 x 6	EMD24I846	EMD24I846R	12.70	15.24
2 x 7	EMD24I847	EMD24I847R	15.24	17.78
2 x 8	EMD24I848	EMD24I848R	17.78	20.32
2 x 9	EMD24I849	EMD24I849R	20.32	22.86
2 x 10	EMD24I8410	EMD24I8410R	22.86	25.40
2 x 11	EMD24I8411	EMD24I8411R	25.40	27.94
2 x 12	EMD24I8412	EMD24I8412R	27.94	30.48
2 x 13	EMD24I8413	EMD24I8413R	30.48	33.02
2 x 14	EMD24I8414	EMD24I8414R	33.02	35.56
2 x 15	EMD24I8415	EMD24I8415R	35.56	38.10
2 x 16	EMD24I8416	EMD24I8416R	38.10	40.64
2 x 17	EMD24I8417	EMD24I8417R	40.64	43.18
2 x 18	EMD24I8418	EMD24I8418R	43.18	45.72
2 x 19	EMD24I8419	EMD24I8419R	45.72	48.26
2 x 20	EMD24I8420	EMD24I8420R	48.26	50.80

N° DI VIE	CODICE		DIMENS. (MM)	
	DRITTI	A 90°	PI	L
2 x 21	EMD24I8421	EMD24I8421R	50.80	53.34
2 x 22	EMD24I8422	EMD24I8422R	53.34	55.88
2 x 23	EMD24I8423	EMD24I8423R	55.88	58.42
2 x 24	EMD24I8424	EMD24I8424R	58.42	60.96
2 x 25	EMD24I8425	EMD24I8425R	60.96	63.50
2 x 26	EMD24I8426	EMD24I8426R	63.50	66.04
2 x 27	EMD24I8427	EMD24I8427R	66.04	68.58
2 x 28	EMD24I8428	EMD24I8428R	68.58	71.12
2 x 29	EMD24I8429	EMD24I8429R	71.12	73.66
2 x 30	EMD24I8430	EMD24I8430R	73.66	76.20
2 x 31	EMD24I8431	EMD24I8431R	76.20	78.74
2 x 32	EMD24I8432	EMD24I8432R	78.74	81.28
2 x 33	EMD24I8433	EMD24I8433R	81.28	83.82
2 x 34	EMD24I8434	EMD24I8434R	83.82	86.36
2 x 35	EMD24I8435	EMD24I8435R	86.36	88.90
2 x 36	EMD24I8436	EMD24I8436R	88.90	91.44
2 x 37	EMD24I8437	EMD24I8437R	91.44	93.98
2 x 38	EMD24I8438	EMD24I8438R	93.98	96.52
2 x 39	EMD24I8439	EMD24I8439R	96.52	99.06
2 x 40	EMD24I8440	EMD24I8440R	99.06	101.60

# E8810T

## TERMINALI + CONNETTORI

### Terminali

Materiale: Ottone (8810T)  
 Portata massima: 2A @ 250V AC/DC  
 Adatti a fili da AWG #28 - #22  
 Estrattore: EF589  
 Utilizzabili nelle serie: EH2510

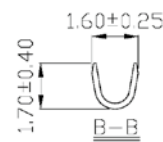
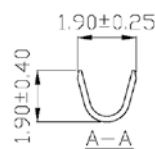
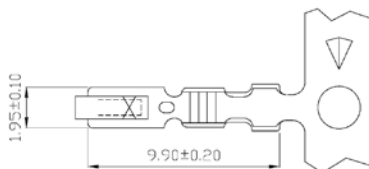
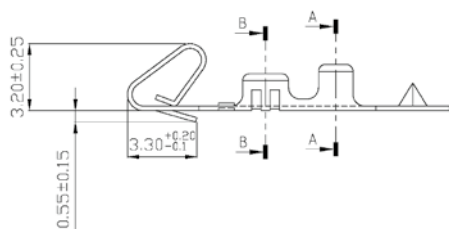
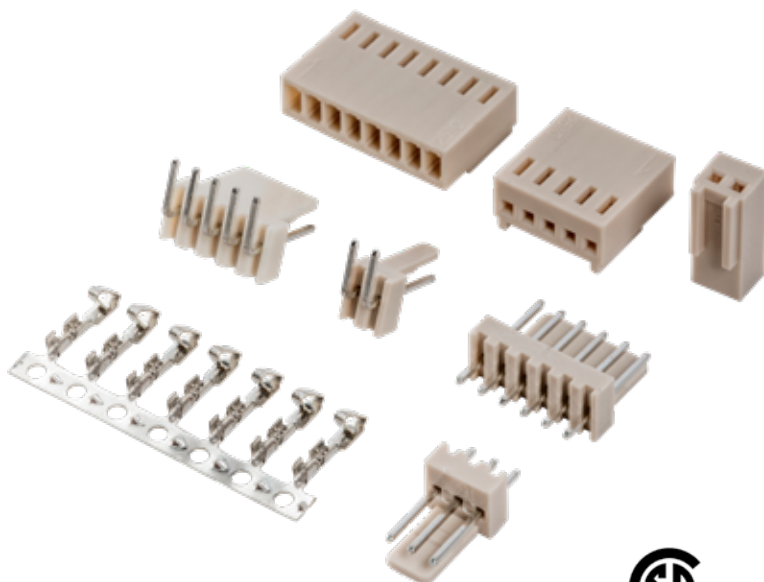

CODICE	SEZ. FILO	MATERIALE	SPESS.	FINITURA	A	B	C	D	DIAM. ISOLANTE	Q.TÀ PER BOBINA
E8810T	AWG 20 - 26	Ottone	0,20	Stagnato	1,90	1,90	1,60	1,70	1,80	10.000pz

# EH2510

## TERMINALI + CONNETTORI

### Connettore

passo 2.54 mm

Materiale: Nylon UL 94V-2  
 Colore standard: Bianco  
 Polarizzazione con "locking ramp"  
 Utilizza Terminali Serie E8810T  
 Interconnessione diretta con  
 le serie: EM241 I-xx / EM241 I-xxR  
 Disponibile da 2 a 20 vie

N° DI VIE	CODICE	DIMENSIONE (MM)	
		PI	L
2	EH2510-02	2.54	5.74
3	EH2510-03	5.08	8.28
4	EH2510-04	7.62	10.82
5	EH2510-05	10.16	13.36
6	EH2510-06	12.70	15.90
7	EH2510-07	15.24	18.44
8	EH2510-08	17.78	20.98
9	EH2510-09	20.32	23.52
10	EH2510-10	22.86	26.06
11	EH2510-11	25.40	28.60
12	EH2510-12	27.94	31.14
13	EH2510-13	30.48	33.68
14	EH2510-14	33.02	36.22
15	EH2510-15	35.56	38.76
16	EH2510-16	38.10	41.30
17	EH2510-17	40.64	43.84
18	EH2510-18	43.18	46.38
19	EH2510-19	45.72	48.92
20	EH2510-20	48.26	51.46

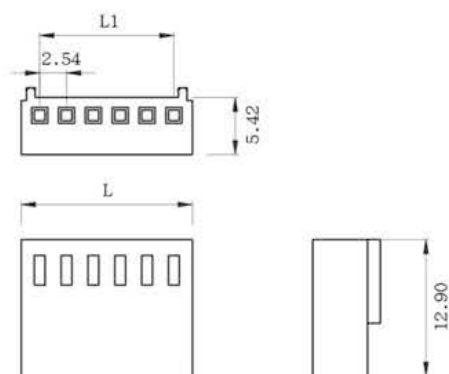

# EM24 I I / EM24 I IR

## TERMINALI + CONNETTORI

Maschi dritti e a 90°  
passo 2.54 mm

Materiale: Nylon UL 94V-2

Portata massima: 2A @ 250V AC/DC

Pin quadro (0.64mm) diritto in ottone stagnato

Blocco a frizione

Interconnessione diretta con le serie: EH25 I0 / EH25 I0F

Disponibili da 2 a 20 vie

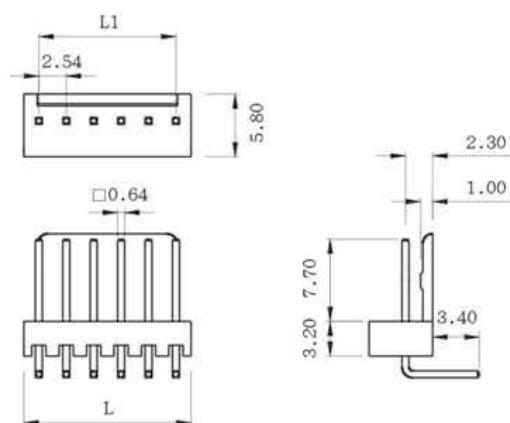
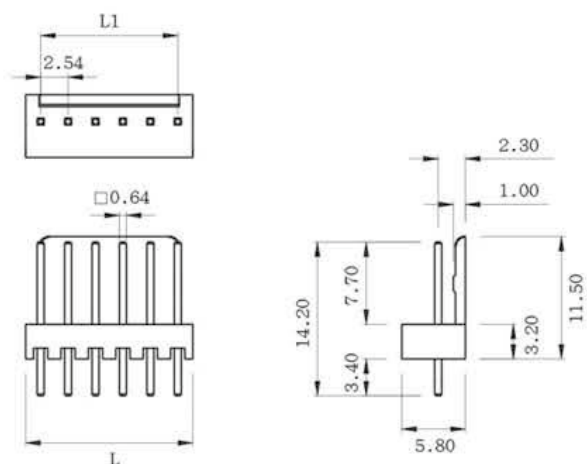

MASCHIO  
DRITTO

MASCHIO  
A 90°

N° DI VIE	CODICE		DIMENSIONI (MM)	
	VERSIONE DRITTA	VERSIONE A 90°	PI	L
2	EM24 I I2	EM24 I I2R	2.54	5.08
3	EM24 I I3	EM24 I I3R	5.08	7.62
4	EM24 I I4	EM24 I I4R	7.62	10.16
5	EM24 I I5	EM24 I I5R	10.16	12.70
6	EM24 I I6	EM24 I I6R	12.70	15.24
7	EM24 I I7	EM24 I I7R	15.24	17.78
8	EM24 I I8	EM24 I I8R	17.78	20.32
9	EM24 I I9	EM24 I I9R	20.32	22.86
10	EM24 I I10	EM24 I I10R	22.86	25.40
11	EM24 I I11	EM24 I I11R	25.40	27.94
12	EM24 I I12	EM24 I I12R	27.94	30.48
13	EM24 I I13	EM24 I I13R	30.48	33.02
14	EM24 I I14	EM24 I I14R	33.02	35.56
15	EM24 I I15	EM24 I I15R	35.56	38.10
16	EM24 I I16	EM24 I I16R	38.10	40.64
17	EM24 I I17	EM24 I I17R	40.64	43.18
18	EM24 I I18	EM24 I I18R	43.18	45.72
19	EM24 I I19	EM24 I I19R	45.72	48.26
20	EM24 I I20	EM24 I I20R	48.26	50.80

# EYA2540-T

## TERMINALI + CONNETTORI

### Terminale

Materiale: Bronzo fosforoso stagnato  
 Utilizzato nella Serie: EYA2540-Hxx  
 Portata massima: 3A @ 250V AC/DC  
 AWG #26 - 30  
 Estrattore: **EF589**

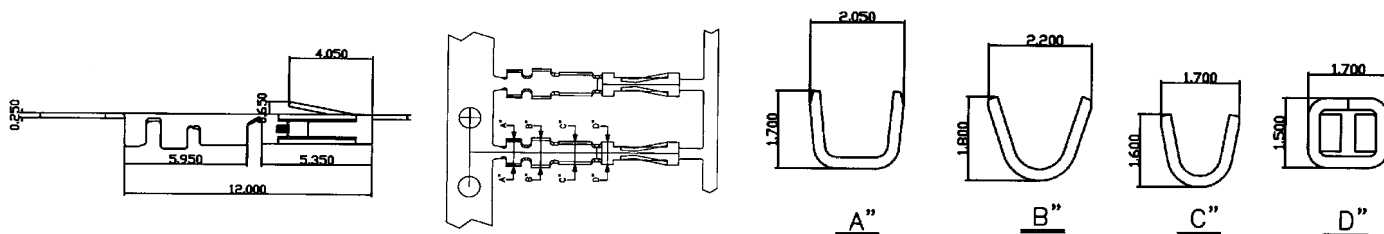

CODICE	SEZ. FILO	MATERIALE	SPESS.	FINITURA	A	B	C	D	DIAM. ISOLANTE	Q.TÀ PER BOBINA
EYA2540-TTAP	AWG 26 - 30	Bronzo Fosf.	0,25	Stagnato	2,20	1,80	1,70	1,60	1,30	15,000pz

\* Gestito anche il terminale maschio ETMOI 128 e le sue plastiche

# EYA2540-H

## TERMINALI + CONNETTORI

### Connettore

passo 2.54 mm

Materiale: P.P.O. - UL94V-I  
 Colore: Nero  
 Passo: 2.54mm  
 Portata massima: 5A @ 250V AC/DC  
 Temperatura di lavoro: da -25° a +85°C  
 Utilizza il terminale EYA2540-T  
 Disponibile da 2 a 22 vie

N° DI POLI	CODICE	A (MM)	B (mm)	C (mm)
2	EYA2540-H02	2.54	5.60	7.00
4	EYA2540-H04	7.62	10.68	12.08
6	EYA2540-H06	12.70	15.76	17.16
8	EYA2540-H08	17.78	20.84	22.24
9	EYA2540-H09	20.23	23.38	24.78
10	EYA2540-H10	22.86	25.92	27.32
12	EYA2540-H12	27.94	31.00	32.40
15	EYA2540-H15	35.56	38.62	40.02
22	EYA2540-H22	53.34	56.40	57.80

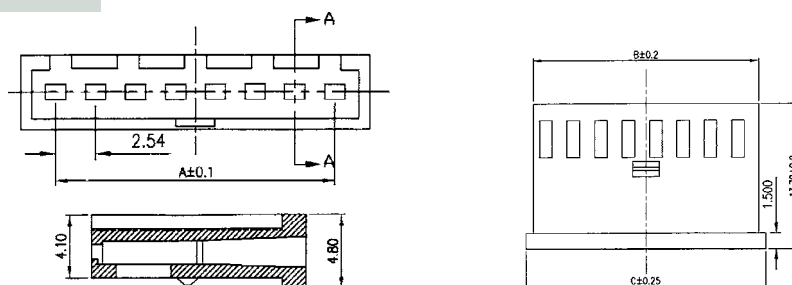
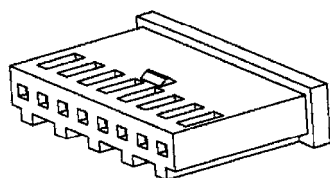

Sezione A - A