

EY5750-T

TERMINALI + CONNETTORI

Connettore porta femmina

Passo 3.00 mm

Per l'uso in tutti gli CONNETTORE serie EC4201H

Per fili da 18 a 22 AWG

Estrattore: **EG177**

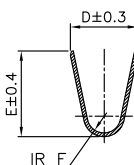
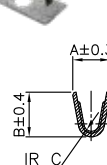
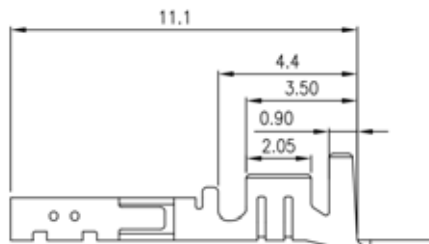
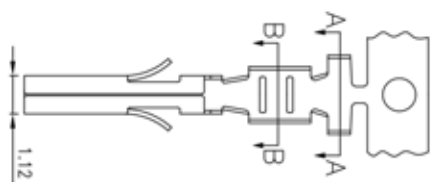

SECT G-G

SECT H-H

CODICE	SEZ. FILO	MATERIALE	SPESS.	FINITURA	A	B	C	D	DIAM. ISOLANTE	Q.TÀ PER BOBINA
EY5750TTAP	AWG 18 - 22	Ottone	0,20	Stagnato	2,70	2,50	2,00	2,30	2,90	10,000pz

EY5750-H

TERMINALI + CONNETTORI

Connettore

Doppia fila da 2 a 24 poli (Standard)

Singola fila da 2 a 12 poli

Materiale: Nylon 66 UL 94V-0

Portata: 5A @ 600V AC/DC

Utilizza terminali EY5750T

Interconnessione diretta con la serie EY5850-H

Colore: Nero

CODICE DOPPIA FILA

CODICE DOPPIA FILA	A (mm)	B (mm)
EY5750-H02		3.85
EY5750-H04	3.00	6.85
EY5750-H06	6.00	9.85
EY5750-H08	9.00	12.85
EY5750-H10	12.00	15.85
EY5750-H12	15.00	18.85
EY5750-H14	18.00	21.85
EY5750-H16	21.00	24.85
EY5750-H18	24.00	27.85
EY5750-H20	27.00	30.85
EY5750-H22	30.00	33.85
EY5750-H24	33.00	36.85

CODICE SINGOLA FILA

CODICE SINGOLA FILA	A (mm)	B (mm)
EY5750-H02S	3.00	7.00
EY5750-H03S	6.00	10.00
EY5750-H04S	9.00	13.00
EY5750-H05S	12.00	16.00
EY5750-H06S	15.00	19.00
EY5750-H07S	18.00	22.00
EY5750-H08S	21.00	25.00
EY5750-H09S	24.00	28.00
EY5750-H10S	27.00	31.00
EY5750-H11S	30.00	34.00
EY5750-H12S	33.00	37.00

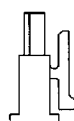
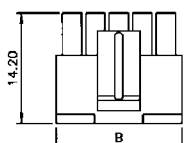
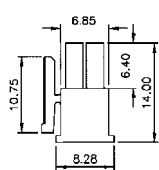
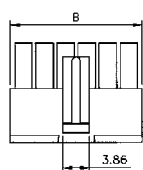
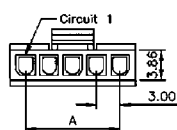
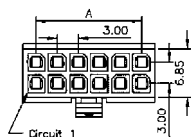

Doppia Fila EY5750-H...S

Fila Singola EY5750-H...S

EY5850-T

TERMINALI + CONNETTORI

Connettore porta maschio passo 3.00 mm

Materiale: Bronzo fosf. stagnato

Per fili da AWG 20 -26

Utilizzato nella serie EY5850-H

Estrattore: **EG177**

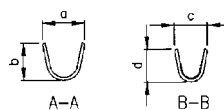
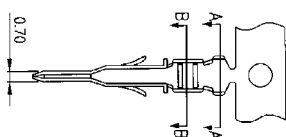
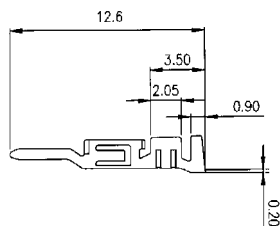

CODICE	SEZ. FILO	MATERIALE	SPESS.	FINITURA	A	B	C	D	DIAM. ISOLANTE	Q.TÀ PER BOBINA
EY5850-TTAP	AWG 20 - 26	Bronzo Fosf.	0,20	Stagnato	2,70	2,40	2,10	2,10	1,85	10,000pz

EY5850-H

TERMINALI + CONNETTORI

Connettore porta maschio passo 3.00 mm

Doppia fila da 2 a 24 poli (Standard)

Singola fila da 2 a 12 poli

Materiale: Nylon 66 UL 94V-0

Portata: 5A @ 600V AC/DC

Utilizza terminali EY5850-T

Interconnessione diretta con la serie EY5750-H

Disponibile in versione con alette di fissaggio a pannello (**versione "E" con ali**) o senza.

Disponible in versione con alette di fissaggio a pannello (**versione "E" con ali**) o senza.

Colore: Nero

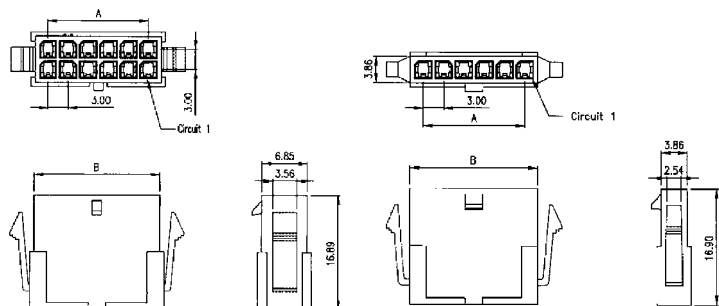

CODICE (DOPPIA FILA)	A (mm)	B (mm)
EY5850-H02(E)		3.85
EY5850-H04(E)	3.00	6.85
EY5850-H06(E)	6.00	9.85
EY5850-H08(E)	9.00	12.85
EY5850-H10(E)	12.00	15.85
EY5850-H12(E)	15.00	18.85
EY5850-H14(E)	18.00	21.85
EY5850-H16(E)	21.00	24.85
EY5850-H18(E)	24.00	27.85
EY5850-H20(E)	27.00	30.85
EY5850-H22(E)	30.00	33.85
EY5850-H24(E)	33.00	36.85
CODICE (SINGOLA FILA)	A (mm)	B (mm)
EY5850-H02S(E)	3.00	7.00
EY5850-H03S(E)	6.00	10.00
EY5850-H04S(E)	9.00	13.00
EY5850-H05S(E)	12.00	16.00
EY5850-H06S(E)	15.00	19.00
EY5850-H07S(E)	18.00	22.00
EY5850-H08S(E)	21.00	25.00
EY5850-H09S(E)	24.00	28.00
EY5850-H10S(E)	27.00	31.00
EY5850-H11S(E)	30.00	34.00
EY5850-H12S(E)	33.00	37.00

Doppia Fila EY5850-H...(E)

Fila Singola EY5850-H...S(E)

EY5950-WST/RT

TERMINALI + CONNETTORI

Maschi dritti a 90°

Passo 3.00 mm

Corpo plastico: PBT 30% GF - UL 94V-0

Contatti: Ottone stagnato

Portata: 5A @ 250VAC o DC



CODICE (TERMINALI DRITTI)	A (mm)	B (mm)
EY5950-W02ST		6.65
EY5950-W04ST	3.00	9.65
EY5950-W06ST	6.00	12.65
EY5950-W08ST	9.00	15.65
EY5950-W10ST	12.00	18.65
EY5950-W12ST	15.00	21.65
EY5950-W14ST	18.00	24.65
EY5950-W16ST	21.00	27.65
EY5950-W18ST	24.00	30.65
EY5950-W20ST	27.00	33.65
EY5950-W22ST	30.00	36.65
EY5950-W24ST	33.00	39.65

CODICE (TERMINALI A 90°)	A (mm)	B (mm)
EY5950-W02RT		6.65
EY5950-W04RT	3.00	9.65
EY5950-W06RT	6.00	12.65
EY5950-W08RT	9.00	15.65
EY5950-W10RT	12.00	18.65
EY5950-W12RT	15.00	21.65
EY5950-W14RT	18.00	24.65
EY5950-W16RT	21.00	27.65
EY5950-W18RT	24.00	30.65
EY5950-W20RT	27.00	33.65
EY5950-W22RT	30.00	36.65
EY5950-W24RT	33.00	39.65

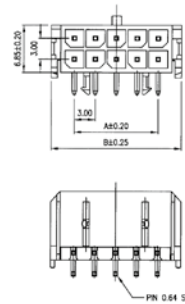
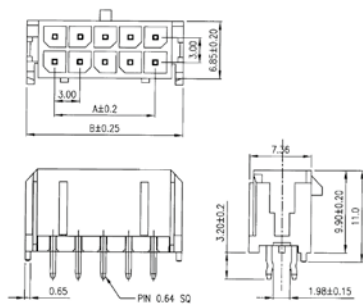

MASCHIO
DRITTO

MASCHIO
A 90°