

EC420 I / EC4202

TERMINALI + CONNETTORI

Connettore
passo 4.20 mm

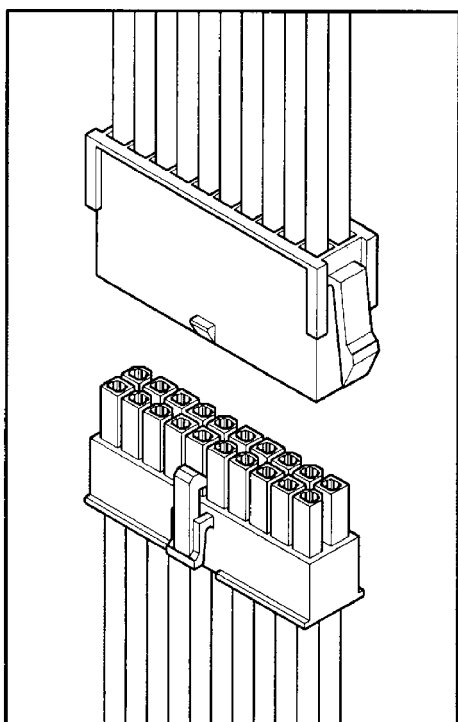

Caratteristiche Tecniche Generali:

N° DI VIE	2 // 24 POLI
Passo	4.2mm
Tensione di lavoro	250V AC – DC
Corrente di lavoro	3 // 7A
Tensione massima applicabile	1500V AC/1 minuto
Resistenza di contatto	10mΩ (massimo)
Resistenza di isolamento	1000MΩ (minimo)
Temperatura di lavoro	-25°C / +85°C°
Massimo spessore del pannello	0.8 – 2.0mm
Diametro del filo	AWG #16 // #22
Forza di inserzione del terminale	1.5 Kg (massimo)
Forza di ritenzione del terminale	3.0 Hg (minimo)
Forza di inserzione (per pin)	600 g (massimo)
Forza di estrazione (per pin)	380 g (minimo)

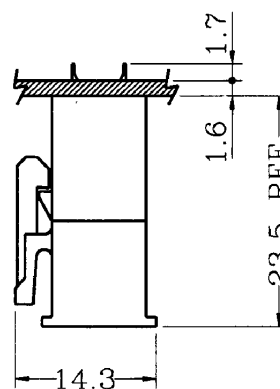
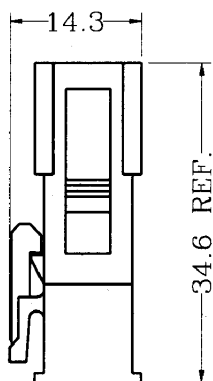

Assemblaggio tipo
filo - Scheda

Assemblaggio tipo
Filo - Filo

EI0110BS-2

TERMINALI + CONNETTORI

Terminale

Per l'uso in tutti gli CONNETTORE serie EC4201H
 Per fili da 18 a 22 AWG
 Estrattore: **EG171**

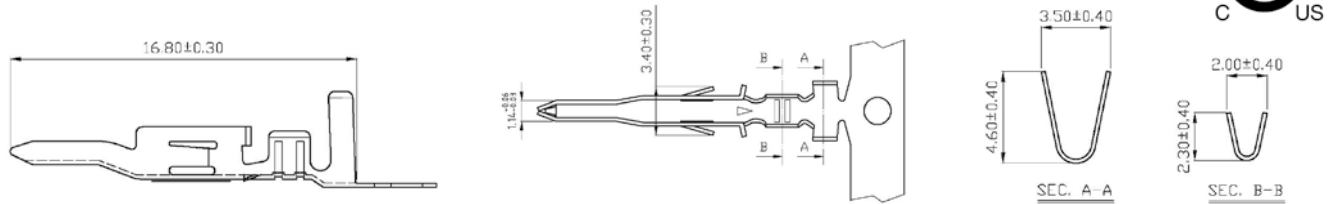

CODICE	SEZ. FILO	MATERIALE	SPESS.	FINITURA	A	B	C	D	DIAM. ISOLANTE	Q.TÀ PER BOBINA
EI0110BS-2	AWG 18 - 22	Ottone	0,20	Stagnato	3,50	4,60	2,00	2,30	2,90	5,000pz

EY5800-T

TERMINALI + CONNETTORI

Terminale

Per l'uso in tutti gli CONNETTORE serie EC4201H0
 Per fili da 16 a 22 AWG

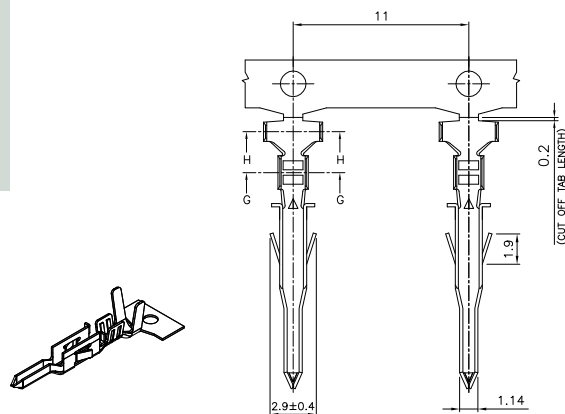
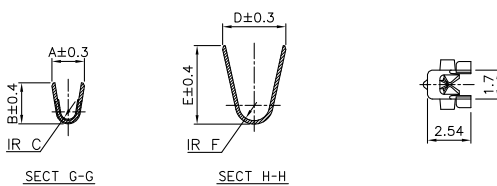
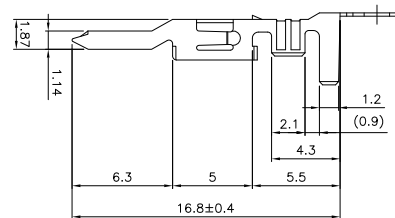

CODICE	SEZ. FILO	MATERIALE	SPESS.	FINITURA	A	B	C	D	DIAM. ISOLANTE	Q.TÀ PER BOBINA
EY5800-TTAL	AWG 16	Ottone	0,20	Stagnato	3,60	4,50	2,30	2,70	3,10	5,000pz

EC420IH

TERMINALI + CONNETTORI

Connettore

passo 4.20 mm

Doppia Fila da 2 a 24 poli

Singola Fila da 3 a 5 poli

Materiale: Nylon 66 UL 94V-2 (UL 94V-0 a richiesta)

Accetta i terminali serie E10110BS-2 / EY5800

Interconnessione con la serie EC4202H0

Disponibile anche in versione senza ali di fissaggio

NR DI VIE	CODICE DOPPIA FILA	DIMENSIONI (MM)	
		A	B
2 x 1	EC420IH02-2x1		5.40
2 x 2	EC420IH02-2x2	4.20	9.60
2 x 3	EC420IH02-2x3	8.40	13.80
2 x 4	EC420IH02-2x4	13.60	18.00
2 x 5	EC420IH02-2x5	16.80	22.20
2 x 6	EC420IH02-2x6	21.00	26.40
2 x 7	EC420IH02-2x7	25.20	30.60
2 x 8	EC420IH02-2x8	29.40	34.80
2 x 9	EC420IH02-2x9	33.60	39.00
2 x 10	EC420IH02-2x10	37.80	43.20
2 x 11	EC420IH02-2x11	42.00	47.40
2 x 12	EC420IH02-2x12	46.20	51.60

NR DI VIE	CODICE FILA SINGOLA	DIMENSIONI (MM)	
		A	B
1 x 3	EC420IH02-1x3	13.80	8.40
1 x 4	EC420IH02-1x4	18.00	13.60
1 x 5	EC420IH02-1x5	22.20	16.80

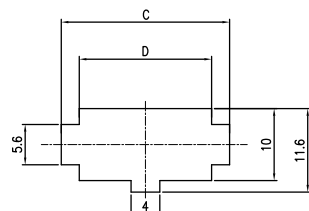
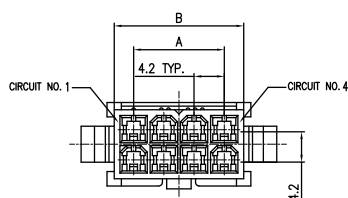

RECOMMENDED PANEL CUT-OUT

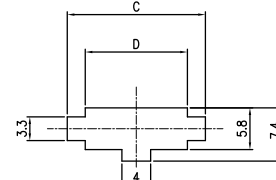
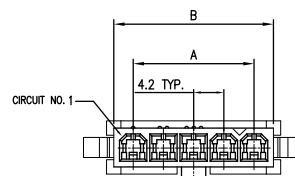

RECOMMENDED PANEL CUT-OUT

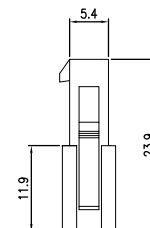
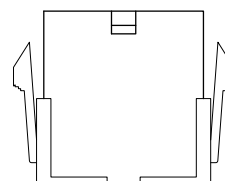
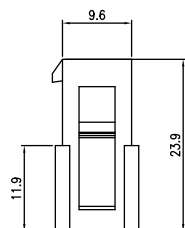
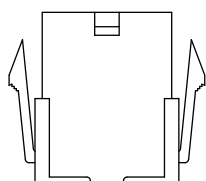

Doppia
Fila (standard)

EC420IH02-2X...

Singola
Fila

EC420IH02-1x3
EC420IH02-1x4
EC420IH02-1x5

E5800-HS

TERMINALI + CONNETTORI

Connettore passo 4.20 mm senza ali di fissaggio

Doppia Fila da 2 a 24 poli senza ali di fissaggio
 Singola Fila da 3 a 5 poli senza ali di fissaggio
 Materiale: Nylon 66 UL 94V-2 (UL 94V-0 a richiesta)
 Accetta i terminali serie E10110BS-2 / EY5800
 Interconnessione con la serie EC4202H0

N° DI VIE	CODICE DOPPIA FILA	DIMENSIONI (mm)	
		A	B
2 x 1	EY5800-H02S		5.40
2 x 2	EY5800-H04S	4.20	9.60
2 x 3	EY5800-H06S	8.40	13.80
2 x 4	EY5800-H08S	13.60	18.00
2 x 5	EY5800-H10S	16.80	22.20
2 x 6	EY5800-H12S	21.00	26.40
2 x 7	EY5800-H14S	25.20	30.60
2 x 8	EY5800-H16S	29.40	34.80
2 x 9	EY5800-H18S	33.60	39.00
2 x 10	EY5800-H20S	37.80	43.20
2 x 11	EY5800-H22S	42.00	47.40
2 x 12	EY5800-H24S	46.20	51.60

N° DI VIE	CODICE FILA SINGOLA	DIMENSIONI (mm)	
		A	B
1 x 3	EY5800-H03SF	13.80	8.40
1 x 4	EY5800-H04SF	18.00	13.60
1 x 5	EY5800-H05SF	22.20	16.80

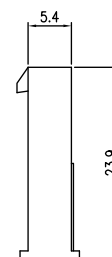
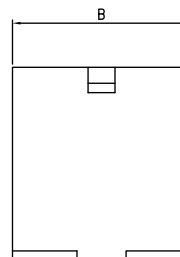
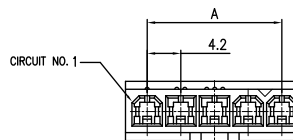
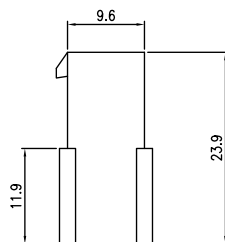
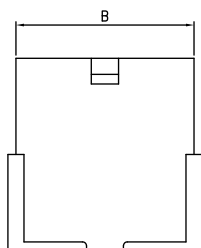
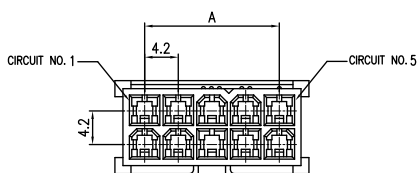

Doppia Fila
senza ali di fissaggio

EY5800H...S

Lineari
senza linea di fissaggio

EY5800H03SF
EY5800H04SF
EY5800H05SF

EIII10BS-2

TERMINALI + CONNETTORI

Terminale

Per l'uso in tutti gli CONNETTORE serie EC4202H0

Per fili da 18 a 22 AWG

Estrattore EG171

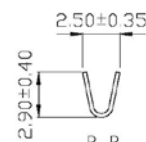
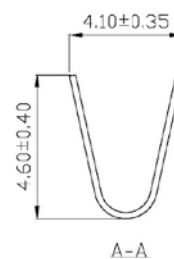
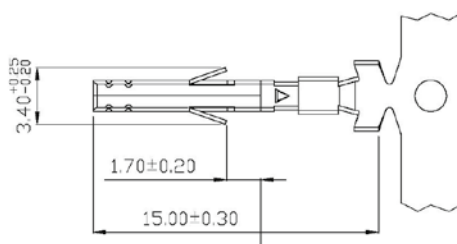
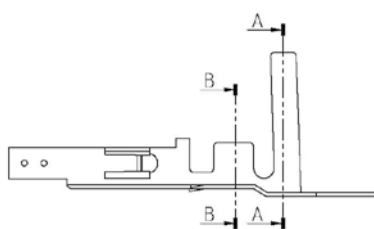
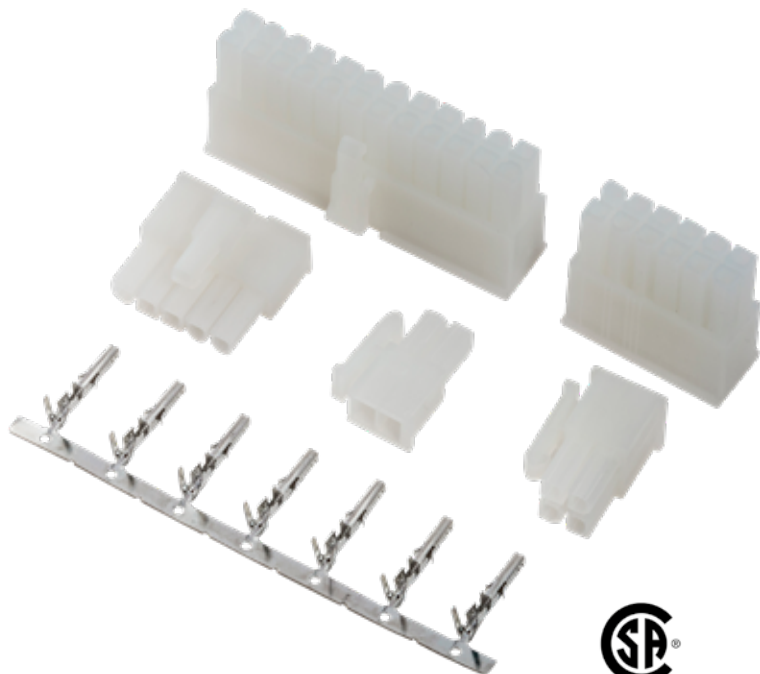

CODICE	SEZ. FILO	MATERIALE	SPESS.	FINITURA	A	B	C	D	DIAM. ISOLANTE	Q.TÀ PER BOBINA
EIII10BS-2	AWG 18 - 24	Ottone	0,20	Stagnato	4,10	4,60	2,50	2,90	2,90	5.000pz

EY5700-T

TERMINALI + CONNETTORI

Terminale

Per l'uso in tutti gli CONNETTORE serie EC4202H0

Per fili da 16 a 22 AWG

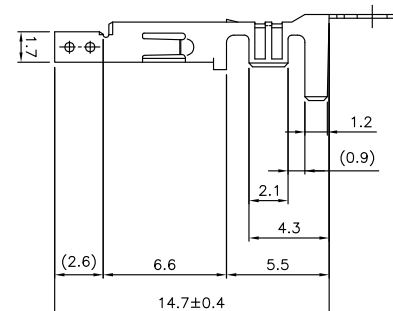
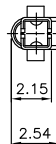
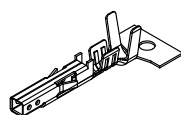
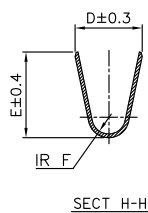
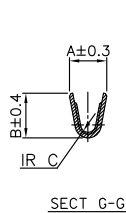
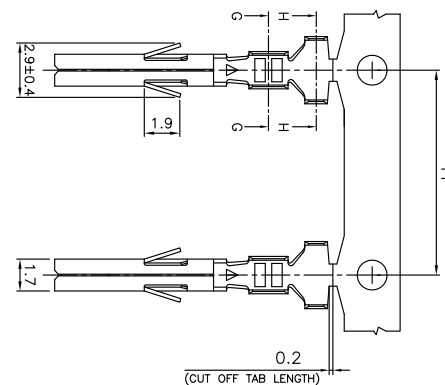

CODICE	SEZ. FILO	MATERIALE	SPESS.	FINITURA	A	B	C	D	DIAM. ISOLANTE	Q.TÀ PER BOBINA
EY5700-TTAL	AWG 16	Ottone	0,20	Stagnato	3,60	4,50	2,30	2,70	3,10	6.000pz

EC4202H

TERMINALI + CONNETTORI

Connettore passo 4.20 mm

Doppia Fila da 2 a 24 poli

Singola fila da 3 a 5 poli

Materiale: Nylon 66 UL 94V-2 (UL 94V-0 a richiesta)

Accetta terminali serie EI | I | OBS-2 / EY5700-TTAB / EY5700-TTABL

Interconnessione con la serie EC4201H02

NR DI VIE	CODICE DOPPIA FILA	DIMENSIONI (MM)	
		A	B
2 x 1	EC4202H02-2x1		5.60
2 x 2	EC4202H02-2x2	4.20	9.80
2 x 3	EC4202H02-2x3	8.40	14.00
2 x 4	EC4202H02-2x4	13.60	18.20
2 x 5	EC4202H02-2x5	16.80	22.40
2 x 6	EC4202H02-2x6	21.00	26.60
2 x 7	EC4202H02-2x7	25.20	30.80
2 x 8	EC4202H02-2x8	29.40	35.00
2 x 9	EC4202H02-2x9	33.60	39.20
2 x 10	EC4202H02-2x10	37.80	43.40
2 x 11	EC4202H02-2x11	42.00	47.60
2 x 12	EC4202H02-2x12	46.20	51.80

NR DI VIE	CODICE FILA SINGOLA	DIMENSIONI (MM)	
		A	B
1 x 3	EC4202H02-1x3	13.80	8.40
1 x 4	EC4202H02-1x4	18.00	13.60
1 x 5	EC4202H02-1x5	22.20	16.80

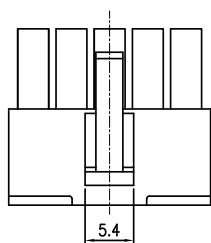
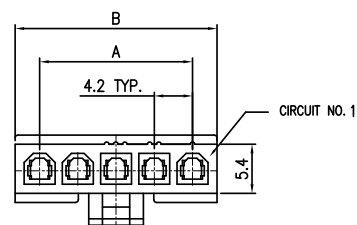
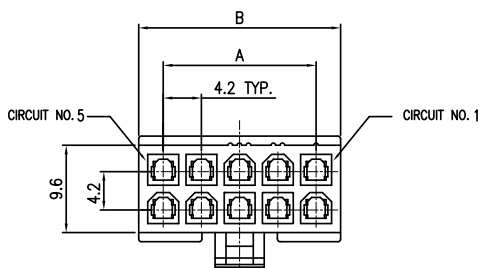

2 CIRCUIT

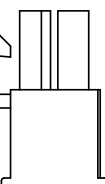
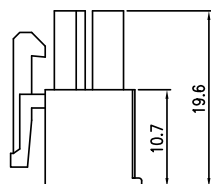

4~24 CIRCUIT

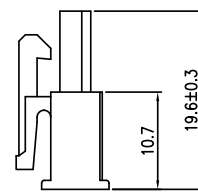
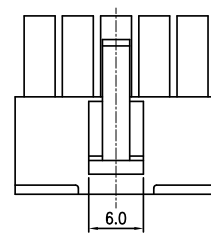

Doppia
Fila

EC4202H02-2x...

Fila
Singola

EC4202H02-1x3
EC4202H02-1x4
EC4202H02-1x5

EY5900-WST

TERMINALI + CONNETTORI

Maschi dritti passo 4.20mm

Disponibile da 2 a 24 poli

Isolante: Nylon 66 UL 94V-2

Contatti: Pin quadro
da 1.14mm – Ottone stagnato

Interconnessione con la serie: EC4202H

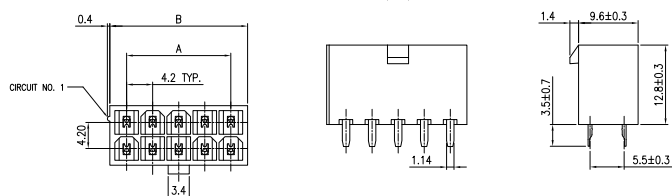
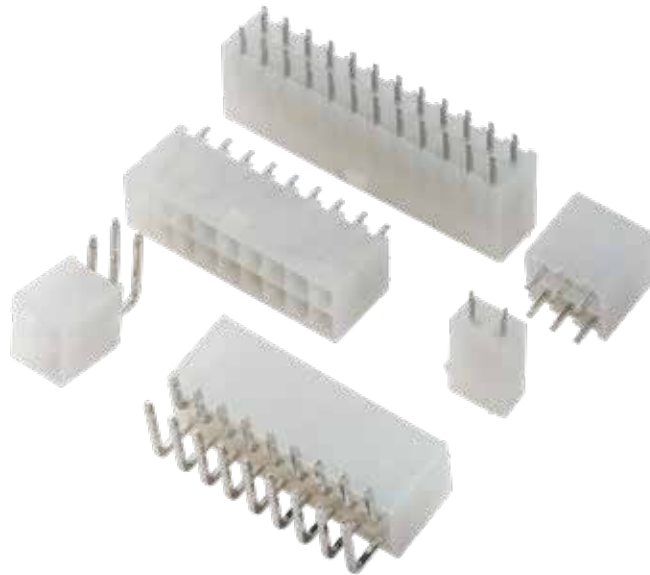

NR DI VIE	COD. ELMAC SENZA PEG	DIMENSIONI (MM)	
		A	B
2 x 1	EY5900-W02ST		5.40
2 x 2	EY5900-W04ST	4.20	9.60
2 x 3	EY5900-W06ST	8.40	13.80
2 x 4	EY5900-W08ST	12.60	18.00
2 x 5	EY5900-W10ST	16.80	22.20
2 x 6	EY5900-W12ST	21.00	26.40
2 x 7	EY5900-W14ST	25.20	30.60
2 x 8	EY5900-W16ST	29.40	34.80
2 x 9	EY5900-W18ST	33.60	39.00
2 x 10	EY5900-W20ST	37.80	42.20
2 x 11	EY5900-W22ST	42.00	47.40
2 x 12	EY5900-W24ST	46.20	51.60

EY5900-WRT

TERMINALI + CONNETTORI

Maschi a 90° passo 4.20 mm

Disponibile da 2 a 24 Poli

Isolante Nylon 66 UL 94V-2 (UL 94V-0 a richiesta)

Contatti: Pin quadro da 1.14mm – Ottone stagnato

Interconnessione con la serie EC4202H0

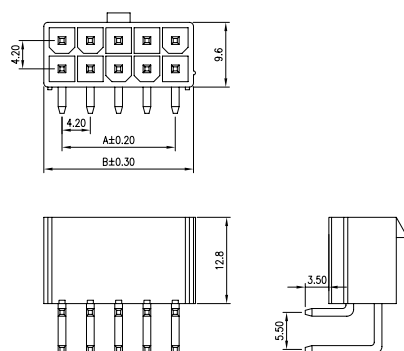

NR DI VIE	COD. ELMAC SENZA ALI	DIMENSIONI (MM)	
		A	B
2 x 1	EY5900-W02RT		5.60
2 x 2	EY5900-W04RT	4.20	9.80
2 x 3	EY5900-W06RT	8.40	14.00
2 x 4	EY5900-W08RT	12.60	18.20
2 x 5	EY5900-W10RT	16.80	22.40
2 x 6	EY5900-W12RT	21.00	26.60
2 x 7	EY5900-W14RT	25.20	30.80
2 x 8	EY5900-W16RT	29.40	35.00
2 x 9	EY5900-W18RT	33.60	39.20
2 x 10	EY5900-W20RT	37.80	43.40
2 x 11	EY5900-W22RT	42.00	47.60
2 x 12	EY5900-W24RT	46.20	51.80